

Really, it's that easy?

Yes, the Retrofire is the most versatile, efficient upgrade for tough insert applications.

The Retrofire is specifically designed to retro fit into factory-built wood fireplaces that conventional gas inserts cannot. Fully functioning in masonry applications, the Retrofire can even accommodate arched or uneven facings.

Nestled within your existing fireplace opening, the Retrofire does not require a front or trim for installation. However, the Retrofire has a full glass window and heat exchanger engineered to provide energy efficient radiant heat. Complete the look from our selection of three beautifully crafted cast iron fenders.

Retrofire has been designed and tested to operate with existing fire screens whether opened or closed. Glass doors must be removed.

With a gas log set the damper is always open, exhausting heat up the chimney and not in your home and in turn consuming three times the amount of gas. Combined with higher combustion air demand causing unwanted cold drafts, a gas log set is an economic and environmental disaster.

On the other hand, the direct vent Retrofire efficiently functions through a sealed firebox, eliminating cold air drafts into your home. Advanced burner technology creates the ambient look and steady radiant heat of a natural flame. In addition, firebox heat exchangers naturally re-circulate warm air through your home completely eliminating the need for a fan.

retrofire

STOP WASTING YOUR MONEY

Now there's a quick and easy way to turn your existing fireplace into an energy efficient heat source.

Engineered to keep the heat in your home, the Retrofire is designed for installation in most masonry or factory-built fireplaces. The direct vent model is room sealed and vented to the air outside your home, completely eliminating smoke, messy ashes and cold drafts.

FEATURES & BENEFITS

- Steady, even, radiant heat
- Quick installation
- Low operating costs
- Energy efficient alternative
- No chimney heat loss
- Ambience of a real log fire
- Easy to use programmable remote control
- No exterior work needed for your existing hearth or mantel
- Three styles to choose from - see below

Programmable Remote Control

- Standard with every Retrofire fireplace
- A timer sets your fireplace to turn on and off any time of day
- Choose the room temperature to maintain your exact comfort level
- Adjust your flame height for the perfect ambience



How to tell if you need a B-Vent or Direct Vent

The Retrofire can be vented using B-vent or direct vent technology. This feature gives you more options when converting from your existing fireplace.

Direct Vent Retrofire – Two chimney liners, room sealed and draws air from outside. This is the preferred choice in most applications.

B-Vent Retrofire – One chimney liner and draws air from inside your home.

- Smaller size chimneys
- Replaces existing conventionally vented gas fireplace
- Extreme cold climates – B-vent is less likely to experience terminal ice-up

[See back spec page for diagrams of both venting applications]

Retrofire
Before & After
Installation



Miles Retrofire shown with Traditional Fender (Black)
Installed in a masonry fireplace with existing custom door frame and draw screen (glass removed)

RETROFIRE FENDER OPTIONS



Avant-Garde Fender - Vintage Iron



Contemporary Fender - Vintage Iron



Traditional Fender - Black

RETROFIRE COMPONENTS

A	RF24BN	Retrofire - B-Vent - Natural Gas
A	RF24BP	Retrofire - B-Vent - Propane
A	RF24DN	Retrofire - Direct Vent - Natural Gas
A	RF24DP	Retrofire - Direct Vent - Propane
B	RA24AV	Avant-Garde Fender - Vintage Iron
B	RA24CV	Contemporary Fender - Vintage Iron
B	RA24TB	Traditional Fender - Black
O	RA24ZC	Retrofire Zero Clearance Kit
O	RA24DS	Draw Screen
O	RA24FS	Fixed Screen
O	743FVI	FenderFire Double Door Front **
O	744FVI	FenderFire Single Door Front **
O	715CVI	Cast Surround **
O	746CTK	3 Sided Contour Trim -Black **
O	746VIK	3 Sided Contour Trim - Vintage Iron **
O	747DTK	3 Sided Deluxe Trim - Black **
O	747VIK	3 Sided Deluxe Trim - Vintage Iron **
O	748CTK	4 Sided Contour Trim -Black **
O	748VIK	4 Sided Contour Trim - Vintage Iron **
O	749DTK	4 Sided Deluxe Trim - Black **
O	749VIK	4 Sided Deluxe Trim - Vintage Iron **

Valor compatible accessories available ** Ask your local Valor dealer about our Legend G3 accessories that are compatible with the Retrofire.

MODEL/FUEL

Model	Fuel	Max. Input BTU/hr	Min. Input BTU/hr	EnerGuide Rating P4.1	Steady State Efficiency (w/out fan)
RF24BN	NG	20,500	12,500	54.2%	67.3%
RF24BP	LP	19,000	12,500	54.2%	67.3%
RF24DN	NG	24,000	10,500	58.8%	67.6%
RF24DP	LP	24,000	10,500	58.8%	67.6%

Certified to ANSI Z21.88 / CSA 2.33 Vented Gas Fireplace Heaters. CSA 2.17 Appliances for Use at High Altitude.

Visit www.milesfireplaces.com for our complete line of gas and electric fireplaces for your home.

VENTING APPLICATIONS - B-VENT / DIRECT VENT

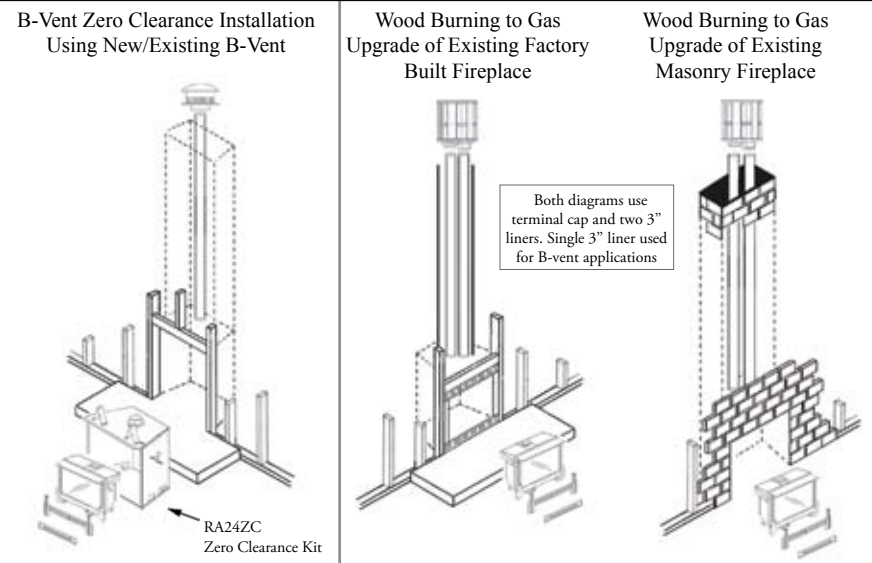

MIN. FRAMING DIMENSIONS
(For Retrofire Zero Clearance Kit)

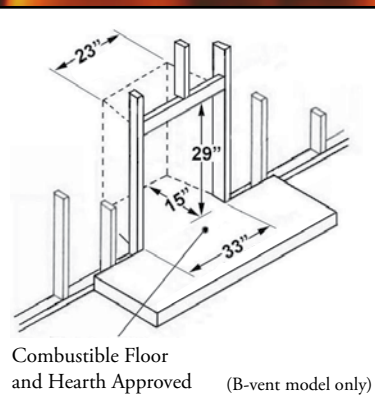

MIN. CAVITY REQUIREMENTS
(Existing Fireplace)

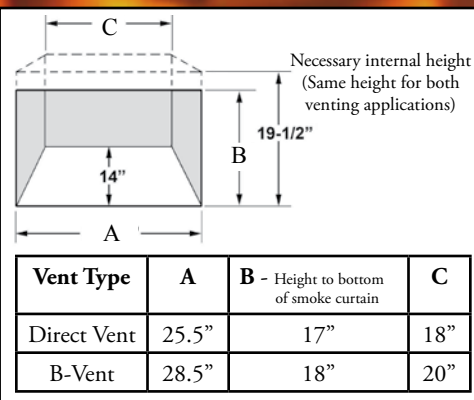

DECORATIVE CAST IRON FENDERS

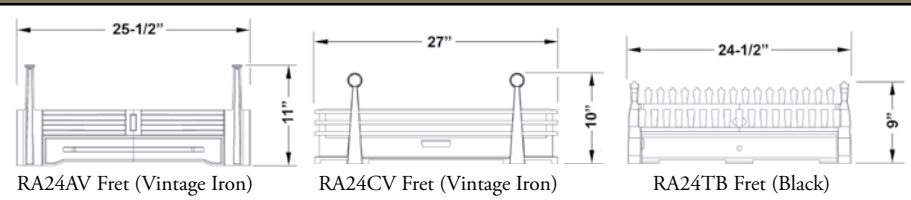

All material is accurate at time of printing and is subject to change. Colours may not be exactly as shown. To ensure you have selected the correct product for your home, visit your local Miles/Valor fireplace dealer. There, you will find live burning units that perfectly match the fireplace you have in mind.

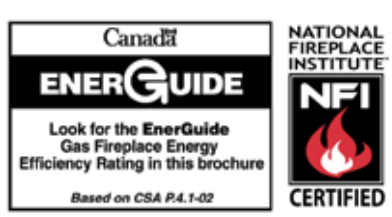

Your Retrofire Dealer:

Designed and manufactured by/for:
MILES INDUSTRIES
Copyright Miles Industries Ltd. 2007
Printed on recycled paper

MILES
FIREPLACES
www.milesfireplaces.com

