



COLUMBIA BAY INSERT
DIRECT VENT GAS FIREPLACE INSERT

QUADRA-FIRE[®]
NOTHING BURNS LIKE A QUAD



COLUMBIA BAY INSERT



Shown with standard black door and rod grille and panels with gold trim

The Columbia Bay Insert from Quadra-Fire turns an ordinary fireplace into a thing of beauty, and a night at home into family memories around the fire. Enjoy the romantic glow from a fire so real you'll be looking for the woodpile. Door crowns and grilles in gold or satin nickel add the perfect finishing touch to the view through the large bay window. You'll also enjoy the high efficiency and outstanding performance of the Columbia Bay Insert.

The TrueGlow Burner, an exclusive from Quadra-Fire, sets a new standard for realism. The ceramic burner is molded from real wood pieces and coals. Flames rise from gas ports distributed throughout the glowing coal bed and lower logs, producing an incredibly active and varied fire. No need to hide the burner anymore—the TrueGlow burner proudly takes center stage, with an appearance that is phenomenal whether it's burning or not.



Shown with optional satin nickel door and rod grille

Standard Features

- Expansive bay window
- TrueGlow burner
- PyroGlo "real wood" logs
- Black door/rod grille
- Ceramic brick refractory interior
- Durable steel construction
- Automatic, 160 cfm variable speed blower
- Manufactured home approved
- Bedroom approved
- Limited Lifetime Warranty

Options

- Door crown in gold or satin nickel
- Rod grille in gold or satin nickel
- Two panel sizes with gold or satin nickel
- Thermostatic remote controls
- Wall thermostat

Cover photo: Columbia Bay Insert shown with optional gold door crown and rod grille, and panel with gold trim



1445 North Highway, Colville, WA 99114
www.quadrafire.com • 800-926-4356

QDF-1009U-1009

Dimensions

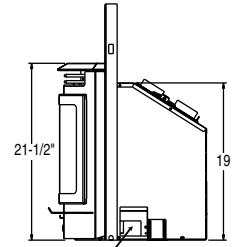
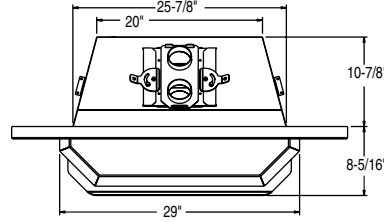

Rocker switch & wiring, Electrical Connection, and Gas Connection accessible here.

Clearances

- A Top Plate to 8" Deep Mantel 13"
- B Top Plate to 3/4" Trim Above..... 10"
- C Top Plate to Side Wall..... 10"
- D Top Plate to 3/4" Trim at Sides 7"

Up to 8" Deep Mantel:
13" From Top of Stove

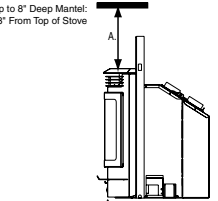

MINIMUM FIREBOX OPENING

- Height - Front: 19" Rear: 13-1/2"
- Width - Front: 26" Rear: 20"
- Depth - Top: 13" Bottom: 13"

PANEL SIZES

- Standard..... 28" x 40"
- Medium 31" x 44"

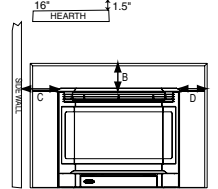

Technical & Performance Data

- Shipping Weight..... 146 lbs.
- Flue Size 3" co-linear
- Standing Pilot Ignition..... Yes
- Convection Blower 160 cfm

- Heating Capacity* ... up to 1,500 sq. ft.
- Btu/Hour Input NG* ... 20,000 - 30,000
- Btu/Hour Input LP* 23,000 - 30,000

U.S. Efficiencies

Steady State - Since most homeowners use their appliance for an extended time while they are in the room, Steady State measure how efficiently your appliance converts fuel to heat once it is warmed up and running in a "steady state".

AFUE - AFUE rating is more typically used with appliances, like your furnace, that continually cycle on and off to maintain a constant temperature.

U. S. EFFICIENCIES			
Steady State		AFUE	
NG	LP	NG	LP
83.07	84.66	68.94	70.06

Canada Efficiencies

EnerGuide (CSA P.4.1-02) - EnerGuide is a rating used in Canada to measure annual efficiency.

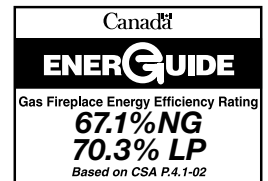

Limited Lifetime Warranty**

The strongest in the industry, Quadra-Fire provides a limited lifetime warranty on the most important aspects: firebox and heat exchanger.

** For full warranty details go to www.quadrafire.com

IMPORTANT - READ BEFORE YOU INSTALL!

Refer to the Owner/Installation Manual for complete clearance requirements and specifications. The images and descriptions in this brochure are provided to assist you in product selection only.

*Heating capacity rating and Btus are to be used as a guideline only. Actual performance may differ slightly due to climate, building construction and condition, amount and quality of insulation, location of the heater, and air movement in the room.

Quadra-Fire is a registered trademark of Hearth & Home Technologies. Product specifications and pricing subject to change without notice. The Quadra-Fire Columbia Bay Insert direct vent gas appliance listed to ANSI standard Z21.88-2002/CSA 2.33-2002 Vented Gas Fireplace Heaters and applicable sections of UL307b Gas Burning Heating Appliances for Manufactured Homes and Recreational Vehicles, CAN/CBA 2.17-M91 "Gas Fired Appliances for Use at High Altitude," by OMNI-Test Laboratories, Inc., Beaverton, OR.

Available From: